



KLH®

PROJECT

THE EAGLE

LOCATION

Kreischberg,
Austria

MOUNTAIN TOP RESORT KREISCHBERG

At the request of the client to create a diamond or rock-shaped building for a new peak restaurant, the architect decided to design the building as an abstracted eagle in a resting pose. The central theme was to find a building form was to capture the fantastic panorama.

A room height of 6 meters and glass panels of the same height offer probably the most spectacular view of landscape. The remaining parts of facade also consists completely of glass, divided into opaque and transparent panels whereby no pane of glass is identical to another.

The guest room was defined with large visible glue laminated timber and KLH® - ceiling elements. In the design of the interior, the materials of wood, stone, felt and leather were combined in a perfect interplay.

The KLH® - CLT elements were delivered via the ski slope of the six-seater chairlift.

PROJECT INFO

VOLUME OF KLH® - CLT
552 m² / 130 m³

STORED CARBON

102 tonnes (Regrowth time in Austria - 2 min)

AWARDS

- 3x Big SEE Awards 2021 for Tourism Interior and Architecture
- A' Design Silver Award
- Iconic Award for Architecture 2021
- ADC Awards 2022 | Gold Winner - Hospitality Medium Architecture Built
- LOOP Design Awards 2023 Caption Winner





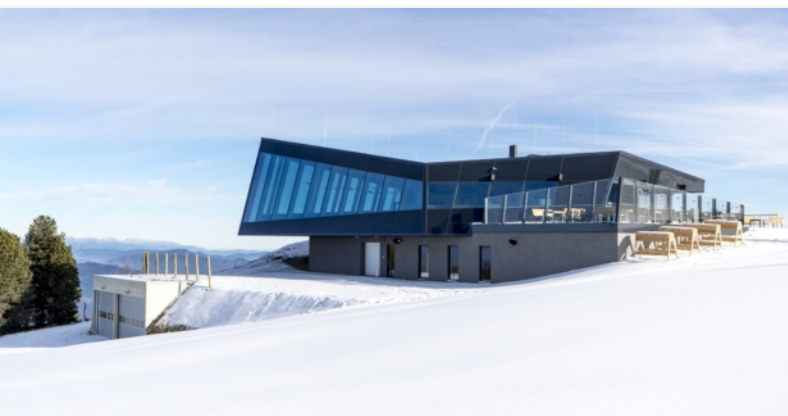

.....
ARCHITECT

Viereck Architekten ZT GmbH
www.viereck.at

.....
STRUCTURAL ENGINEERING

Laubreyter Bauingenieur ZT GmbH
www.laubreyter.at

.....
CLIENT

Kreischberg Seilbahnen Betriebs GmbH
www.kreischberg.at

.....
PHOTOGRAPHY CREDITS

Tom Lamm
Gladik Bau GmbH